

GERMAN
POOL

Cordless Mini Chopper

BLD-WL45



USER MANUAL

Please read these instructions and warranty information carefully before use and keep them handy for future reference.

Warnings and Safety Precautions

1. Fully charge this product before you use it first time.
2. Make sure the blade unit is installed in place properly and runs smoothly, before any food is put in this product.
3. DO NOT scratch this product with anything sharp.
4. It is strictly prohibited to overload this product.
5. DO NOT heat up this product in a microwave oven or freeze it in a refrigerator, otherwise this product will break. The maximum water temperature for washing and sterilizing this product is 100°C.
6. DO NOT use this product to crush hard food such as coffee beans, beans, rice, ice cubes or frozen food.
7. When this product is working, it's strictly prohibited to touch any of its detachable parts such as blades, motors, etc., in order to avoid injury or damage to this product.
8. It's designed that this product won't work continuously for more than 30 seconds. If you need this product to work again, wait for 2 minutes. If this product has continuously worked for 3 times, with an interval of 2 minutes between each time, wait for 30 minutes before you make it work for the 4th time. This is to protect the product and make sure it lasts long time.
9. The blades are very sharp. DO NOT touch them with naked fingers during installation, cleaning, etc. Hold the plastic pillar of the blade unit when you are doing so.
10. DO NOT use steel wool, abrasive cleaners or aggressive liquids (such as gasoline or acetone) to clean this product. The bottom of the main body can be quickly rinsed with clean water at a slanted angle (DO NOT wet the push button part).
11. DO NOT dip the main body in water.
12. DO NOT leave any part of this product being washed in the dishwasher.
13. This product should be stored in a place that is not easily accessed by children. DO NOT let persons (including children) who are physically impaired, feel or mentally impaired, or lack of relevant experience and knowledge use or play with this product.
14. This product is only suitable for personal or household use, not for commercial use.
15. **⚠ WARNING!** Be careful not to get cut by the sharp blades when removing food from the product, or when removing the blades for cleaning.

Product Structure

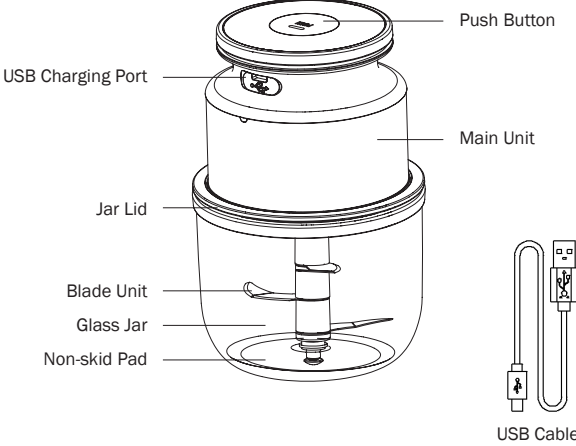

Operation Instruction

- Note:**
- Fully charge this product before using it for the first time. When fully charged, indicator light lights up constant in blue.
 - Wash the blade unit, jar lid and glass jar before use.

1. Install the blade unit onto the shaft at the bottom of the jar, then place clean food into the jar (DO NOT fill to above the Max level indicated on the jar).

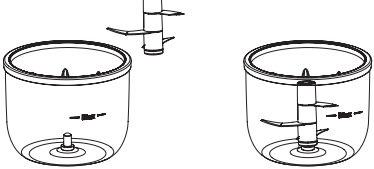

2. After placing in the food, place on the jar lid, and place on the main unit (align the grooves on the base of the main unit with the ribs on the jar lid). Indicator light blinks in blue for 5 times.
3. Press Push Button to start chopping. If the jar is overfilled, the blades will not turn; if this happens, please take out part of the food then press Push Button again.

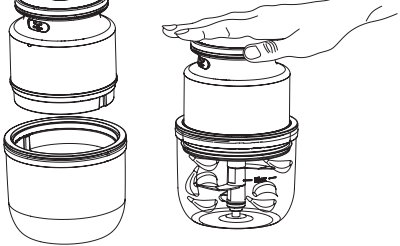

- Note:**
- The maximum duration per use is 30 seconds. If user long-presses Push Button for more than 30 seconds, the product will automatically stop after 30 seconds.
 - If user requires the food to be chopped even more finely, please wait 2 minutes before long-pressing Push Button again.

4. After chopping, take off the main unit and the jar lid, and carefully remove the blade unit before pouring out the food.

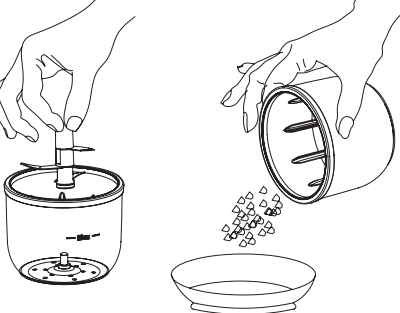

Operation Instruction

Indicator Lights Explained

| Indicator Light | Status |
|---|--|
| Lights up constant in red | Charging |
| Lights up constant in blue | Fully charged |
| Blinks in blue for 5 times | Motor and blade engaged (When the main unit is properly fitted onto the jar lid) |
| Blinks alternately in blue and red for 10 times | Motor and blade disengaged (When the main unit is lifted off the jar lid) |
| Lights up in blue | In use (When Push Button is pressed) |
| Lights up in red for 3 seconds | Low battery |

- Note:**
- This product is designed to work in short spurts of no more than 30 seconds each. If product has worked continuously for 30 seconds, user must wait 2 minutes before using it again. If product has continuously worked for 3 times (30 seconds each time with 2 minutes rest between each time), wait for 30 minutes before using it again. This is to protect the motor of the product.

Cleaning and Maintenance

- ⚠ WARNING!**
- This product must be unplugged from the power source and blade unit must be detached from the main unit before cleaning and maintenance.
 - DO NOT immerse or directly rinse main unit with water.

1. Please clean the main unit, blade unit and glass jar promptly after use.
2. The bottom of the main body can be quickly rinsed with clean water at a slanted angle (DO NOT wet the push button part), or wiped clean with a warm soft cloth.
3. Glass jar, jar lid and blade unit can be washed with soft cloth and water diluted with detergent. Use warm water for better result.
4. The blades are very sharp. DO NOT touch them with your hands. To avoid injury, the water used for washing the blades must be very clear so that you can see the blades clearly.
5. DO NOT use abrasive or corrosive cleansers to clean this product.
6. DO NOT sterilize this product and its accessories with high heat.
7. After cleaning, wipe dry or air dry the main unit and accessories completely (DO NOT touch the blade unit with your hand), reassemble and store away.
8. If this product will not be used for an extended period of time, please charge the battery every 3 months, this will help to prolong the battery life.

Troubleshooting

| Problem | Indicator Light | Possible Cause | Solution |
|--|--|---|--|
| Push Button is pressed but product does not start | Indicator light blinks alternately in red and blue | Main unit is not properly attached to the glass jar | Attach main unit and glass jar properly |
| | Indicator light lights up in red for 3 seconds | Low battery | Charge the battery |
| | Indicator light lights up constant in blue | Motor is damaged or stuck | Turn the motor axle; if motor still will not turn, contact German Pool Customer Service & Repair Centre |
| Product cannot charge | Indicator light does not light up | Check if the USB cable is loose | Connect USB cable firmly or replace with a new cable |
| Motor emits a strange smell when using for the first few times | / | This is a normal phenomenon | If motor still smells after using for many times, contact German Pool Customer Service & Repair Centre |
| Blades will not turn | / | Blades are entangled or jammed by food | Take off the main unit, take out the food and cut into smaller pieces, or chop the food in smaller batches |

- ⚠ WARNING!**
- The above are the common fault analysis and troubleshooting methods. For other problems, please contact German Pool Customer Service & Repair Centre. DO NOT disassemble and repair this product by yourself.

Technical Specification

| Model | BLD-WL45 |
|----------------------------|-------------------------|
| Output Voltage | DC 3.7 V |
| Output Power | 45 W |
| Max. Duration for Each Use | 30 seconds |
| Product Dimensions | (H)150 (W)100 (D)100 mm |
| Net Weight | 0.62 kg |

- Specification is subject to change without prior notice.
- If there is any inconsistency or ambiguity between the English version and the Chinese version, the Chinese version shall prevail.
- Refer to www.germanpool.com for the most update version of the user manual.

保用條款

此保用提供德國寶產品之機件在正常使用下壹年保用 (由購買日起計算)。

- 客戶若能在機身卡夾內，以下列其中一種方式向本公司登記資料，保用手續方式如下：
 - 1) 透過德國寶APP手機應用程式保用登記表 (請參閱右二碼)
 - 2) 填妥本公司經銷保用登記表 www.germanpool.com/warranty
 - 3) 填妥保用卡郵寄至本公司。

Warranty Terms & Conditions

Under normal operations, the product will guarantee a 1-year full warranty provided by German Pool effective from the date of purchase.

- This warranty is not valid until customer registration information is received by our Service Centre within 10 days of purchase via one of the following means:
 - 1) Visit our VIP App and register online: (Scan the QR Codes on the left)
 - 2) Visit our website and register online: www.germanpool.com/warranty
 - 3) Complete the attached Warranty Card and mail it back to our Customer Service Centre.

另請填寫以下表格並與正本發票一併保存，以便備時核對資料。用戶提供之所有資料必須正確無誤，否則免責保用將會失效。Please fill out the form below. This information and the original purchase invoice will be required for any repairs. Warranty will be invalidated if information provided is found to be inaccurate.

型號 Model No.: BLD-WL45

機身號碼 Serial No.: _____

發票號碼 Invoice No.: _____

購買商號 Purchased From: _____

購買日期 Purchase Date: _____

1. 未能出示購買發票正本者，將不獲免費維修服務。
2. 用戶應依照說明書的指示操作。本保用並不包括：
 - 上門安裝、檢修、維修或更換零件之人工以及一切運輸費用；
 - 因天然與人為意外造成的損壞 (包括運輸及其他)；
 - 電源接合不當、不依說明書而錯誤或疏忽使用本機所引起之損壞。
3. 於下列情況下，用戶之保用資格將被取消：
 - 購買發票有任何涂改或之更改；
 - 產品被用作商業或工業用途；
 - 產品被非認可之技師人員修改或加裝任何配件；
 - 機身編號被擅自塗改、破壞或刪除。
4. 總代理有權選擇維修或更換配件或其機體部份。
5. 產品一經被轉讓，其用期視操作而失效。

Customer Service & Repair Centre

中國香港

九龍大馬路19號
三灣大廈海濱中心地下B座
電話：+852 2333 6249
傳真：+852 2366 9798
電郵：repair@germanpool.com

中國澳門

澳門青洲大馬路(青洲新街)
515號美蘭廣場第二期1樓A座
電話：+853 2875 2699
傳真：+853 2875 2681

Hong Kong, China

Unit 8, G/F, Sunshine Kowloon Bldg
Cargu Centre, 59 Tai Yip Street, Kowloon
Tel : +852 2333 6249
Fax : +852 2366 9798
Email : repair@germanpool.com

Macau, China

A.1 Ande, Mei Ku Kiang D'ourgoise Bldg
No.515 Avenida Do Conselheiro Bolo
Tel : +853 2875 2699
Tel : +853 2875 2681

警告及注意事項

1. 本產品為便捷式料理機，第一次使用前必須對此產品進行充電。
2. 加入食材前，必須確保刀片安裝到位，運轉自如。
3. 嚴禁使用尖銳物體刮擦本產品。
4. 嚴禁本產品超負荷使用。
5. 嚴禁將本產品放置於微波爐加熱或冰箱冷凍，以免造成本產品破裂，料理杯最高耐溫可以用100°C沸水殺菌清洗。
6. 本產品不能用來加工過硬的食物，例如：咖啡豆、大豆、阿膠、大米、冰塊或冷凍食物等類似食材。
7. 本產品工作時，嚴禁接觸到刀片、摩打等可拆卸部件，以免受傷害或使產品受損。
8. 本產品連續工作時間不能超過30秒，連續工作30秒後，需休息2分鐘後才能使用。以工作30秒間隔2分鐘為一週期，連續工作三個週期後必須讓產品冷卻30分鐘後再工作，以保證產品壽命。
9. 刀片很鋒利，嚴禁用手直接接觸刀片，取出或安裝時鑷住片上的刀杆。
10. 嚴禁使用鋼絲絨、研磨性清潔劑或腐蝕性液體 (例如汽油或丙酮) 來清洗本產品。可以直接用清水斜著沖洗主機底部 (無按鍵的部份) ，嚴禁將主機浸入水中。
11. 嚴禁將本產品任何部份放入洗碗機內清洗。
12. 本產品應僅存在兒童不易觸及的地方，嚴禁讓肢體不健全，感覺或精神上有障礙或缺乏相關經驗和知識的人 (包括兒童) 使用或玩弄本產品。
13. 本產品僅適用於個人或家庭使用，不適合商用。
14. **⚠ 警告！** 取出刀片、排空料理杯和清洗時，小心刀片傷手。

產品結構

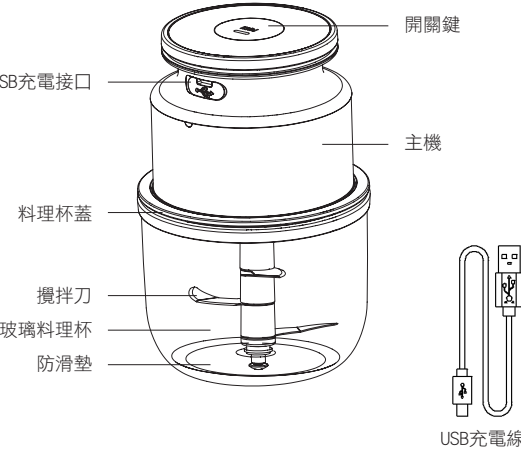

使用說明

- 注意：**
- 首次使用前先將主機充滿電。充滿電後，藍色指示燈常亮。
 - 將攪拌刀、料理杯蓋、玻璃料理杯清洗乾淨。

1. 將攪拌刀裝入玻璃料理杯的刀軸上，再將洗淨的食物放入玻璃料理杯中 (不能超過刻度上限) 。

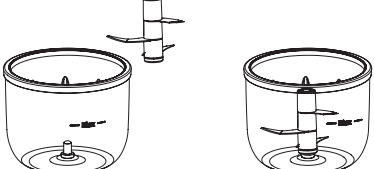

2. 食物裝入玻璃料理杯後，蓋上料理杯蓋，將主機卡槽裝上料理杯蓋對應的卡位上，指示燈以藍色閃爍5次。



3. 按「開關鍵」開始攪拌食物。如食物過多可能卡住攪拌刀不轉，請適當取出一些食物後再按「開關鍵」進行攪拌。

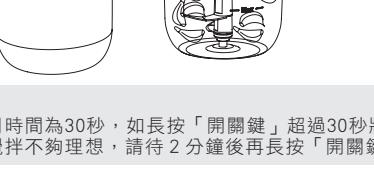

- 注意：**
- 每次最長使用時間為30秒，如長按「開關鍵」超過30秒將自動停機。
 - 如覺得食物攪拌不夠理想，請待2分鐘後再長按「開關鍵」繼續攪拌。



使用說明

指示燈說明

| 指示燈 | 狀態 |
|------------|------------------------------|
| 紅色常亮 | 充電中 |
| 藍色常亮 | 充滿電 |
| 藍色閃爍5次 | 安全開關閉合 (將主機正確裝在玻璃料理杯及料理杯蓋上時) |
| 紅藍色交替閃爍10次 | 安全開關斷開 (從玻璃料理杯蓋抽起主機時) |
| 藍色亮著 | 工作中 (按下開關鍵進行攪拌期間) |
| 紅色常亮3秒 | 電量不足 |

- 注意：**
- 本產品連續工作時間不能超過30秒，連續工作30秒後，需休息2分鐘後才能使用。以工作30秒間隔2分鐘為一週期，連續工作三個週期後必須讓產品冷卻30分鐘後再工作，以保證產品壽命。

清潔與保養

- ⚠ 警告！**
- 清潔和保養前，必須拔除電源插頭及將攪拌刀從主機上拆下。
 - 嚴禁將主機浸入水中或直接沖洗。

1. 本產品使用完後請立即清洗主機、攪拌刀和玻璃料理杯。
2. 清洗本產品時可用手斜著沖洗主機底部 (無按鍵的部份) ，或用柔軟的溫布擦拭。
3. 可在清水中放適量洗潔劑、用軟布進行清洗，用溫水效果更好。
4. 攪拌刀非常鋒利，嚴禁用手接觸。為避免受傷，清洗時水必須非常清澈，使您在清洗過程中能清楚看到攪拌刀。
5. 嚴禁使用研磨性或腐蝕性的清潔劑進行清洗。
6. 嚴禁對本產品各部件進行高溫消毒。
7. 清洗好產品後，必須將產品各部件擦乾或晾乾 (攪拌刀不能用手接觸) ，再重新組裝起來收納。
8. 如長時間不使用本產品，請於三個月內對產品進行一次充電保養。

此保用只適用於香港及澳門 | This warranty is valid only in Hong Kong and Macau