

Auto Chill Cold Brew Coffee Maker | CMV-350



Online Warranty Registration



Please read these instructions and warranty information carefully before use and keep them handy for future reference.

USER MANUAL

請即進行保用登記！
有關保用條款細則，請看說明書最後一頁。

Please register your warranty information now !
For Warranty Terms & Conditions,
please refer to the last page of this user manual.

Table of Contents

Warnings & Safety Precautions	04
Product Structure	05
Operation Instructions	06
Cleaning & Maintenance	08
Troubleshooting	09
Technical Specification	10
Warranty Terms & Conditions	19

Warning & Safety Precautions

WARNING!

Read all instructions carefully before using this product.

- This product is for domestic indoor use only. If this product is used for any commercial, industrial, rental or other purposes, product warranty will be VOIDED.
- This product is not intended for use by children or persons with reduced physical, sensory or mental capabilities, or lack of experience and knowledge, unless they have been given supervision or instruction concerning use of this product by an adult responsible for their safety.
- Mind your children and DO NOT let children play with this product.
- Cleaning and user maintenance shall not be made by children without supervision.
- Check the voltage indicated on the rating label before using this product.
- If the supply cord is damaged, it must be replaced by the manufacturer, its service agent or similarly qualified persons in order to avoid hazards.
- Unplug this product from the power source before cleaning and maintenance.
- Contact German Pool authorized service technician for repair or maintenance of this product.

1. Please read the Instruction Manual carefully before using the product, and keep the Instruction Manual properly for future reference.
2. Please strictly follow the instructions below. Ignorance to any instruction or any operation error may lead to a major accident or other injuries.
3. Please check the specification of the power adapter carefully before use.
4. The product applies to DC 12V. Be sure to use the power adapter provided by our company to guarantee your personal safety.
5. Please put the product on a stable, level surface out of the reach of children.
6. When used, the product should be placed in a well ventilated place without any blocking to the air outlet and inlet.
7. When the product is working, DO NOT move or tilt the liquid inside.
8. DO NOT immerse the maker in water for cleaning or get any liquid into the inner machine to avoid any danger due to short circuit.
9. Dismantling any part for repair without authorization is prohibited, so that any fire, electric leakage or other failure can be avoided.
10. DO NOT let the product work for a long time without being attended to.
11. Rinse the maker in time after using it. Leaving liquid in the maker for more than 2 hours is prohibited, because the high protein in the drink, such as milk, yogurt and other dairy may go bad and produce odor if left inside for a long time.
12. Before turning on the product, please make sure the product is dry and all parts are mounted correctly.
13. If the power cord is damaged, it must be replaced by German Pool Customer Service & Repair Centre's qualified technicians in order to avoid a hazard.
14. The product is for home use only. DO NOT use it for commercial purpose.

Product Structure

Body

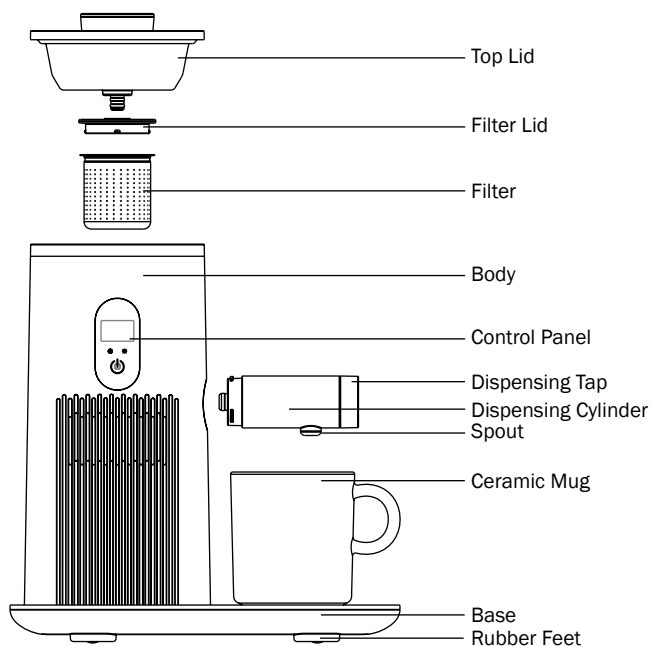

Control Panel

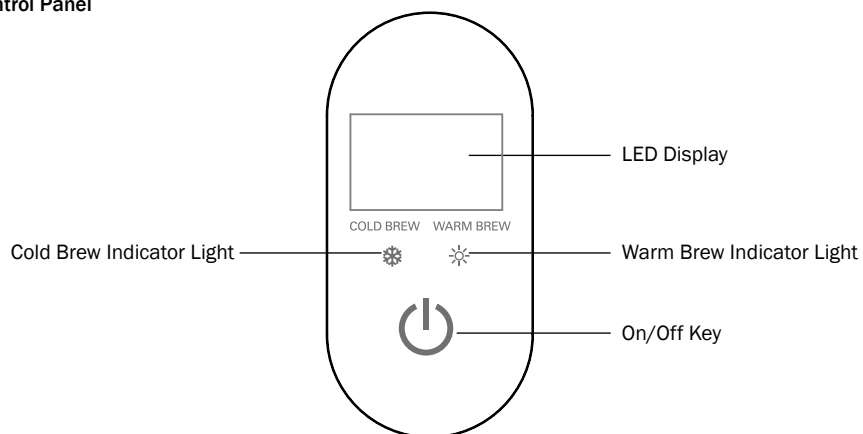

Operation Instructions

Before Use

1. Before using for the first time, please clean the product body and accessories according to the instructions mentioned in "Cleaning and Maintenance" section.
2. Place the product base on a sturdy and level surface, then place the main body on the base.
3. Turn the dispensing tap clockwise to "—" (close) position.
4. Plug the dispensing cylinder onto the product body by aligning the dot with the "Unlock" icon, then turn the cylinder anti-clockwise to lock it in securely (until the dot aligns with the "Lock" icon).

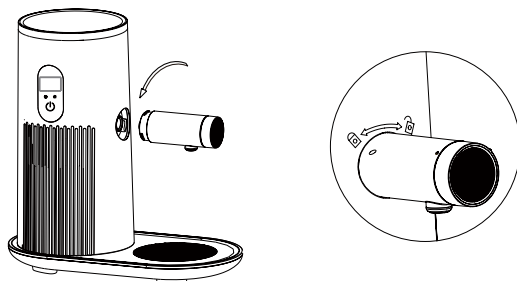

5. Add ground coffee or tea leaves into the filter cup, cover the filter lid, then plug the filter cup onto the bottom of the top lid.

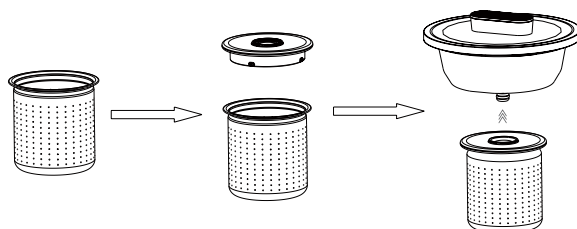

6. Add water into the water tank, then close the top lid.

⚠ WARNING!

- Use only purified or mineral water with this product.
- DO NOT fill to above the maximum water mark.
- Before adding water into the water tank, make sure the dispensing knob is turned to "—" (close) position.
- After filling the water tank, DO NOT unlock or remove the dispensing cylinder, otherwise water will spill out from the machine.

Operation Instructions

Brewing Coffee Or Tea

1. Connect product to the power source, the buzzer will beep once, all indicator lights will light up for 1 second then go dark. LED display will show "OFF", and product enters standby status.
2. Press On/Off key to cycle among "Cold Brew" – "Warm Brew" – standby status.
3. When selecting "Cold Brew" or "Warm Brew", the corresponding indicator light will flash, LED display will show the current water temperature. If the product does not receive any further command in 5 seconds, it will automatically start brewing.

Note:

- When selecting "Cold Brew" mode, long-press On/Off key for 3 seconds to enter "Temperature Setting". When LED display is flashing, press ON/OFF key to select desired temperature of 5 °C - 10 °C - 15 °C. If no further instruction is received in 5 seconds, product will automatically start brewing.
 - This product has built-in memory function. After product is turned off, the next time it is turned on again, if user does not set a new temperature, it will brew at the previously set temperature.
 - There is no temperature selection for "Warm Brew" mode, the product will automatically brew at 55 °C.
4. When product is in the brewing status, press ON/OFF key will stop the brewing process and return the product to standby status.
 5. When the product is in brewing status but does not receive any command, it will automatically turn off and return to standby status after 4 hours.

Note:

Time needed to reach selected temperature may differ according to input water temperature, ambient temperature and input water volume.

WARNING!

- After each use, promptly unplug product from the power source, rinse out the water tank and dispensing cylinder to avoid residual coffee or tea going stale and causing odor.

Tips On Brewing Coffee Or Tea

- For tea: It is recommended to use unfermented or lightly fermented tea leaves, and the recommended tea to water ratio is 1:100 to 2:100.
- For cold brew coffee: It is recommended to use medium-ground coffee powder, and the recommended coffee to water ratio is 1:15 according to individual preference.
- If user prefers a slightly acidic taste, light-roasted coffee is recommended; if user prefers a slightly bitter taste, dark-roasted coffee is recommended.

Cleaning and Maintenance

⚠ WARNING!

- Before cleaning the product, turn off the product and unplug from the power source, and wait until the product has completely cooled down before cleaning.
 - DO NOT immerse the product or top lid in water or rinse it under running water.
-
- After using the product, promptly unplug from the power source.
 - The water tank and top lid may be cleaned with a soft sponge. To avoid damaging the tank coating, DO NOT clean with steel scourer or other hard objects.
 - The outer casing of the product may be wiped clean with moist cloth. DO NOT rinse the main body or top lid with water to avoid causing electric leakage.
 - Use soft brush to clean detachable accessories like the dispensing cylinder and filter cup, then wipe dry or let to air dry.
 - When cleaning the dispensing cylinder, first detach it from the main body, then run a soft brush through the tube to clean it.

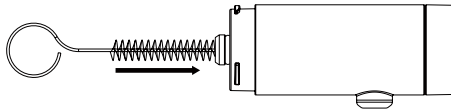

- If the product will not be used for a prolonged period of time, clean it thoroughly and wipe it dry. Detachable accessories should be allowed to air dry completely before storing away in a dry and well-ventilated place, to avoid dampness affecting future use.
- DO NOT immerse the top lid and dispensing cylinder in water to avoid water entering the inner structure.

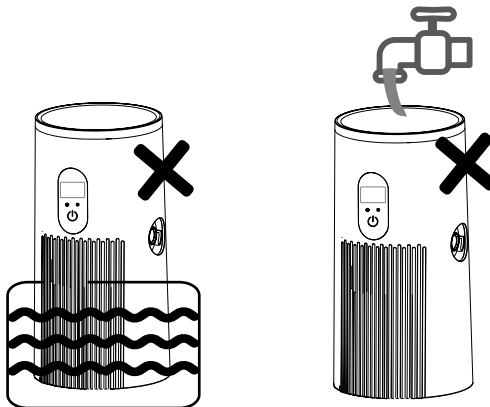

Troubleshooting

Problem	Possible Cause
No power supply	Check whether the power plug is securely plugged in.
LED Display does not light up Product does not work	Product malfunction. Please contact German Pool Customer Service and Repair Centre.
LED panel shows "E1"	Product short circuit. Please contact German Pool Customer Service and Repair Centre.
LED panel shows "E2"	Product open circuit. Please contact German Pool Customer Service and Repair Centre.

WARNING!

If problem persists, please contact German Pool Customer Service and Repair Centre. DO NOT disassemble product unless by a qualified technician.

Technical Specification

Model	CMV-350
Voltage	AC 100 - 240 V
Current	1.2 A
Power	48 W
Frequency	50 / 60 Hz
Water Tank Capacity	350 mL
Temperature Range	5 °C - 55 °C
Product Dimensions	(H)288 (W) 145 (D) 263 mm

- Specification is subject to change without prior notice.
- If there is any inconsistency or ambiguity between the Chinese version and the English version of this user manual, the Chinese version shall prevail.
- Refer to www.germanpool.com for the most updated version.

目錄

警告及注意事項	12
---------	----

產品結構	13
------	----

使用說明	14
------	----

清潔與保養	16
-------	----

故障檢修	17
------	----

技術規格	18
------	----

保用條款	15
------	----

警告及注意事項

⚠ 警告！

使用本產品前，請仔細閱讀所有說明。

- 本產品只限家居室內日常使用，如產品作任何商業、工業、出租或其他用途，保用證即告失效。
- 請勿讓兒童或身體有殘障、精神不健全及對本產品缺乏經驗或知識的人士單獨使用本產品；如需使用，必須要在負責任的成年人監管下方可使用。
- 應照顧好兒童，確保他們不會玩耍本產品。
- 無成年人監管下，勿讓兒童清潔及維護本產品。
- 使用前，請先檢查所有電壓是否與本產品標籤上的電壓相符。
- 如果電源線損壞，為免發生意外，電源線必須由廠方、廠方指定的維修中心或同等合格的技術人員進行更換。
- 清潔或檢查本產品前，必須先關機及拔掉插頭。
- 請聯繫德國寶授權的技術人員進行維修或保養本產品。

1. 使用前必須詳細閱讀本說明書操作指導，並妥善保管以供日後參考。
2. 嚴格遵守以下指示，無視該指示或操作失誤，都可能會造成重大事故或其他傷害的發生。
3. 使用前必須認真檢查電源適配器規格是否相符。
4. 本產品適用於12V直流電源，必須使用本公司提供的電源適配器，以保障人身安全。
5. 使用時產品應放置於穩定平台上，並放置於兒童觸摸不到的地方。
6. 產品使用時應放在通風順暢的地方，嚴禁遮擋出風口或進風口。
7. 產品工作時，嚴禁移動或傾倒壺內液體。
8. 嚴禁將機身浸泡於水中清洗或讓液體流入機器內部，以免造成短路而發生危險。
9. 嚴禁私自拆除零件維修，以免引起火災、漏電或其他故障。
10. 嚴禁在長時間無人看管下運行本產品。
11. 使用完畢後必須及時清洗，嚴禁存留在壺內超過2小時或以上；飲品中含有高蛋白質（如牛奶、乳酪或其他奶製品），時間久會變質而導致壺內產生異味。
12. 使用前必須確保主機乾燥，並確保所有配件均正確安裝。
13. 如果電源軟線損壞，為了避免危險，必須由德國寶客戶服務及維修中心的專業人員更換。
14. 本產品僅限家庭用途，嚴禁用於商業用途。

產品結構

主機及配件

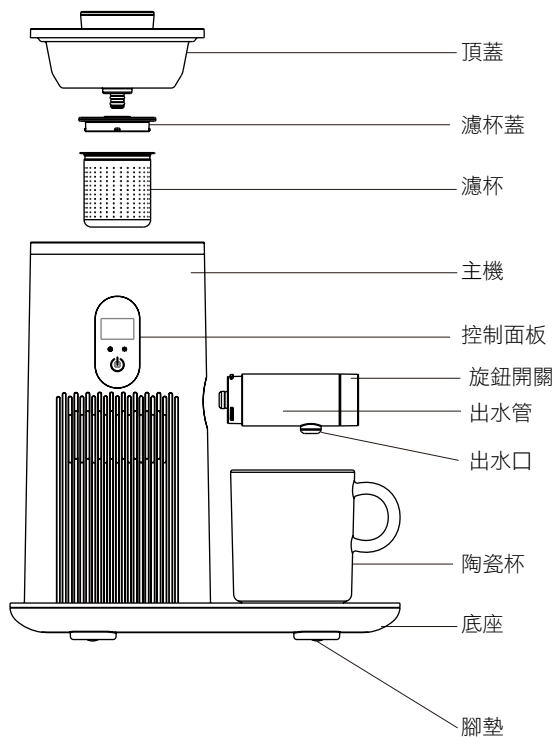

控制面板

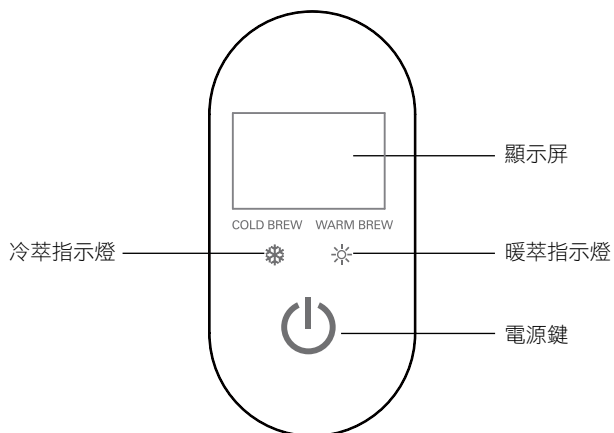

使用說明

使用前準備事項

1. 初次使用前，參照「清潔及保養」部份清潔主機及配件。
2. 將底座放置於平坦且穩固的平面上，並將主機放置於底座上。
3. 將出水管上的旋鈕開關順時針旋轉至關閉“-”狀態。
4. 將出水管圓點圖案對準主機開鎖圖案，將出水管插入主機後逆時針旋緊（出水管圓點圖案對齊主機鎖上圖案）。

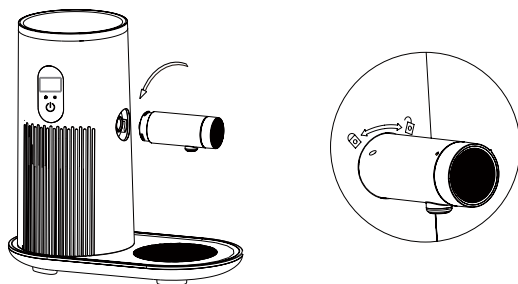

5. 將咖啡粉或茶葉放入濾杯中，蓋上濾杯蓋，將濾杯插入頂蓋上。

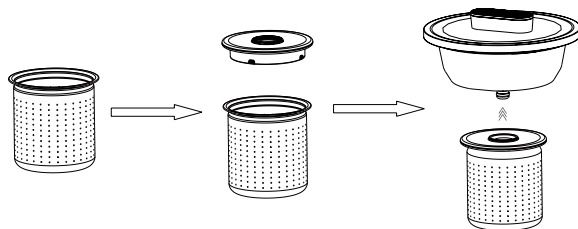

6. 往主機內膽注入適量的水，然後蓋上頂蓋。

⚠ 警告！

- 注水時請使用純淨水或礦泉水。
- 注水時嚴禁超過最高水位線。
- 注水前必須確保出水口為關閉“-”狀態。
- 主機內膽注水後，嚴禁扭開或拆除出水管，否則主機內膽的水會從機身溢出。

使用說明

沖製咖啡或茶

1. 接通電源後，蜂鳴器發出提示聲一聲，指示燈亮著1秒後熄滅，顯示屏顯示「OFF」，進入待機狀態。
2. 按電源鍵循環選擇：冷萃模式 – 加熱模式 – 返回待機狀態。
3. 選擇「冷萃模式」或「加熱模式」時，相應指示燈閃爍，顯示屏顯示當前水溫，如5秒內無任何操作，產品自動進入工作狀態。

注意：

- 選擇「冷萃模式」時，可長按電源鍵3秒進入溫度設定，再按電源鍵循環選擇：5°C–10°C–15°C，如5秒內無任何操作，產品自動進入工作狀態。
 - 本產品設有記憶功能，關機後，下次啟動將默認使用上次所設定的溫度。
 - 「加熱模式」無溫度選擇，產品將自動加熱至55°C。
4. 在工作狀態下，可按電源後鍵停止工作並返回待機狀態。
 5. 如工作狀態下無任何操作，產品將在4小時後自動停止工作並返回待機狀態。

注意：

制冷效果因應注水水溫、環境溫度、水量等因素而有所不同。

⚠ 警告！

- 使用完畢後必須立即拔除電源插頭，並立即清洗主機內膽及出水管，以免殘留食材發生變質，產生異味。

沖製咖啡或茶貼士

- 推薦使用未發酵或輕度發酵的茶葉，茶葉及水的比例建議為1:100至2:100。
- 推薦使用中度研磨咖啡粉，咖啡粉和水的比建議為1:15，此比例可因應個人濃度偏好而調整。
- 如喜歡偏酸口味，建議使用淺度烘焙咖啡粉；如喜歡偏甘口味，建議使用深度烘焙咖啡粉。

清潔與保養

⚠ 警告！

- 清潔咖啡機前必須關機並拔出電源插頭，待機器完全冷卻後再進行清潔。
- 嚴禁將主機及頂蓋浸入水中或直接沖洗。
- 使用完畢後，必須及時從電源插座上拔除電源插頭。
- 主機內膽、頂蓋可用海綿清洗，嚴禁使用鋼絲球等硬質材料清洗，以免損壞內膽表層。
- 主機外表請使用濕抹布清潔，嚴禁以任何液體沖洗主機及頂蓋，以免發生漏電事故。
- 其他可拆卸部件（如出水管、濾杯等），請使用軟刷清潔後風乾或擦乾。
- 清潔出水管時，先將出水管從主機旋出，再用毛刷伸進出水管內清洗內壁。

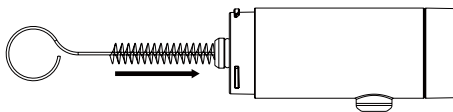

- 如長時間不使用本產品時，請清潔乾淨後擦乾機身，將可拆卸部件完全晾乾後存放於乾燥通風處，以免產品受潮而影響使用。
- 頂蓋及出水管請勿浸泡清洗，以免內部結構進水。

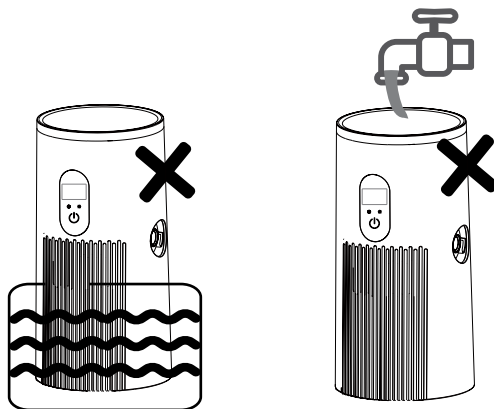

故障檢修

故障情況	可能原因
無法接通電源	檢查電源插頭是否插緊到位
顯示屏不亮/產品不運作	產品故障，請聯絡德國寶客戶服務及維修中心
顯示屏顯示E1	產品短路，請聯絡德國寶客戶服務及維修中心
顯示屏顯示E2	產品開路，請聯絡德國寶客戶服務及維修中心

⚠ 警告！

如無法順利排除故障，請與客戶服務及維修中心聯絡，嚴禁非專業人員對本機拆卸。

技術規格

型號	CMV-350
電壓	AC 100 - 240 V
輸出電流	1.2 A
功率	48 W
頻率	50 / 60 Hz
容量	350 mL
溫度範圍	5°C - 55°C
產品尺寸	(H)288 (W) 145 (D) 263 mm

- 產品規格及設計如有變更，恕不另行通知。
- 中英文版本如有出入，一概以中文版為準。
- 本產品使用說明書以 www.germanpool.com 網上版為最新版本。

保用條款

此保用提供德國寶產品之機件在正常使用下壹年保用(自購買日起計算)。

- * 貴戶須在購機十天內，以下列其中一種方式向本公司登記資料，保用手續方正式生效：

- 1) 填妥本公司網頁內之保用登記表格

www.germanpool.com/warranty

- 2) 填妥保用登記卡，郵寄至本公司。



Warranty Terms & Conditions

Under normal operations, the product will guarantee a 1-year full warranty provided by German Pool (effective from the date of purchase).

- * This warranty is not valid until customer registration information is received by our Service Centre within 10 days of purchase via one of the following means:

- 1) Visit our website and register online:

www.germanpool.com/warranty

- 2) Complete all the fields on the attached Warranty Card and mail it back to our Customer Service Centre.



另請填妥以下表格並與正本發票一併保存，以便維修時核對資料。用戶提供之所有資料必須正確無誤，否則免費保用將會無效。
Please fill out the form below. This information and the original purchase invoice will be required for any repairs. Warranty will be invalidated if information provided is found to be inaccurate.

型號 Model No.: ☐ CMV-350

機身號碼 Serial No.: _____ 發票號碼 Invoice No.: _____

購買商號 Purchased From: _____ 購買日期 Purchase Date: _____

1. 未能出示購買發票正本者，將不獲免費維修服務。

2. 用戶應依照說明書的指示操作。本保用並不包括：

- 上門安裝、檢驗、維修或更換零件之人工以及一切運輸費用；
- 因天然與人為意外造成的損壞 (包括運輸及其他)；
- 電源接合不當、不依說明書而錯誤或疏忽使用本機所引致之損壞。

3. 於下列情況下，用戶之保用資格將被取消：

- 購買發票有任何非認可之刪改；
- 產品被用作商業或工業用途；
- 產品經非認可之技術人員改裝或加裝任何配件；
- 機身編號被擅自塗改、破壞或刪除。

4. 總代理有權選擇維修或更換配件或其損壞部份。

5. 產品一經被轉讓，其保用即被視作無效。

1. Customer who fails to present original purchase invoice will not be eligible for free warranty service.

2. Customer should always follow the operating instructions. This warranty does not apply to:

- labour costs for on-site installation, check-up, repair, replacement of parts and other transportation costs;
- damages caused by accidents of any kind (including material transfer and others);
- operating failures resulting from applying incorrect voltage, improper usage, and unauthorized installations or repairs.

3. This warranty is invalid if:

- the purchase invoice is modified by an unauthorized party;
- the product is used for any commercial or industrial purposes;
- the product is repaired or modified by unauthorized personnel, or unauthorized parts are installed;
- the serial number is modified, damaged or removed from the product.

4. German Pool will, at its discretion, repair or replace any defective part.

5. This warranty will be void if there is any transfer of ownership from the original purchaser.

客戶服務及維修中心

中國香港

九龍大業街59號

三湘九龍灣貨運中心地下B室

電話：+852 2333 6249

傳真：+852 2356 9798

電郵：repairs@germanpool.com

中國澳門

澳門俾利喇街145號

寶豐工業大廈3樓

電話：+853 2875 2699

傳真：+853 2875 2661

Customer Service & Repair Centre

Hong Kong, China

Unit B, G/F, Sunshine Kowloon Bay

Cargo Centre, 59 Tai Yip Street, Kowloon

Kowloon, Hong Kong

Tel : +852 2333 6249

Fax : +852 2356 9798

Email : repairs@germanpool.com

Macau, China

3/F, Edificio Industrial Pou Fung,

145 Rua de Francisco Xavier Pereira,

Macau

Tel : +853 2875 2699

Fax : +853 2875 2661

此保用只適用於香港及澳門

This warranty is valid only in Hong Kong and Macau

German Pool (Hong Kong) Limited

Hong Kong, China

Room 113, Newport Centre Phase II, 116 Ma Tau
Kok Road, Tokwan, Kowloon, Hong Kong.
Tel: +852 2773 2888
Fax: +852 2765 8215

Mainland China

8th, Xinxiang Road, Wusha Industrial Park,
Daliang, Shunde, Foshan, Guangdong
Tel: +86 757 2219 6888
Fax: +86 757 2219 6809

Macau, China

3/F, Edificio Industrial Pou Fung,
145 Rua de Francisco Xavier Pereira, Macau
Tel: +853 2875 2699
Fax: +853 2875 2661



香港《S MARK》
安全認證



中國電器/家電行業
十大影響力品牌



CEO非凡品牌大賞



香港優質商標



香港工商業獎



2007
最具價值
創建品牌企業獎



香港中小企業
最佳拍攝大獎



香港消費者推獎品牌



香港《Q標》
優質服務證書



香港名牌十年成就獎
HONG KONG TOP BRAND TEN YEAR
ACHIEVEMENT AWARD

© All rights reserved. Copying, reproducing or using the contents of this manual is not allowed without prior authorization from German Pool, violators will be prosecuted.