

GERMAN
POOL



德國寶

冰沙乾磨專用杯

Grinder & Smoothie Maker

GSM-10



在使用之前請詳細閱讀「使用說明書」及「保用條例」，並妥為保存。
Please read these instructions and warranty information carefully before use and keep them handy for future reference.



使用說明書 OPERATING INSTRUCTIONS

Table of Contents

Product Structure	03
Operating Instructions	04
- Dry-Grinding Beans	
- Making Dough	
- Making Smoothies & Milkshakes	
Care & Maintenance	05
Warranty Terms & Conditions	11

Product Structure

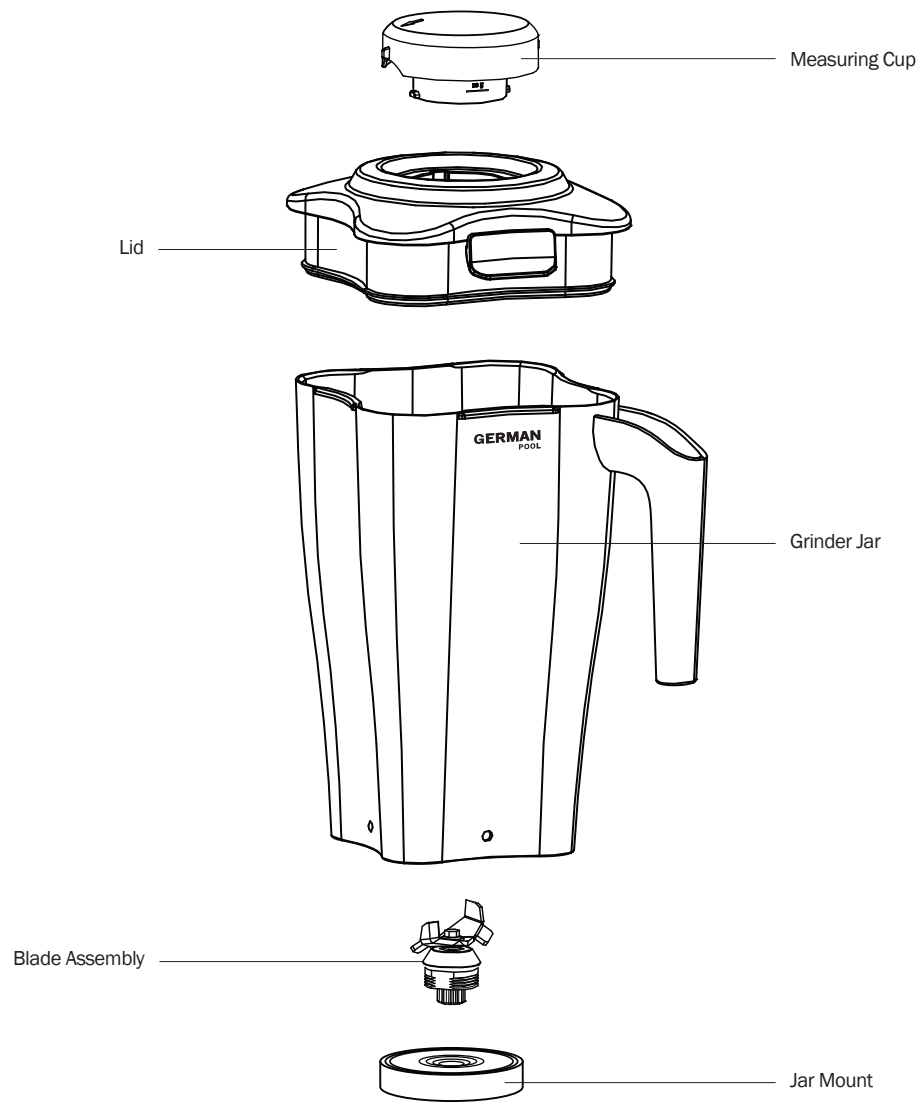

Operating Instructions

Dry-Grinding Beans

Method:

Place Grinder & Smoothie Maker onto the base of Professional High-Speed Food Processor. Put in coffee beans, soybean, rice, brown rice, etc. Press “Nuts” function key to grind into powder.

Making Dough

Method:

Place Grinder & Smoothie Maker onto the base of Professional High-Speed Food Processor. Put in flour and water (reference: flour 250g, water 140ml). Press “Nuts” function key to mix into dough.

Making Smoothies & Milkshakes

Method:

Place Grinder & Smoothie Maker onto the base of Professional High-Speed Food Processor. Put in your desired fruits. Press “Smoothie” function key.

Examples:

Below are some suggested ingredient proportions (please add into the jar in order), which can be adjusted according to personal preference.

Example	Suggested Ingredient Proportion
Mango smoothie	Mango 300g, ice cubes 2 cups, sugar 2 spoons
Mango milkshake	Mango 300g, ice cubes 2cups, milk 1/2 cup, sugar 2 spoons
Strawberry smoothie	Strawberry 300g, ice cubes 2 cups, sugar 1 spoon
Strawberry milkshake	Strawberry 300g, ice cubes 2 cups, milk 1/2cup, sugar 1 spoon
Banana smoothie	Banana 300g, ice cubes 2 cups, sugar 1 spoon
Banana milkshake	Banana 300g, ice cubes 2 cups, milk 1/2 cups , sugar 1 spoon

Care & Maintenance

- Turn off the switch and unplug from the wall outlet.
- Do not immerse the unit base or power cord into water or other liquid.
- Clean the surface of grinder jar with soft cloth or spongy. The measuring cup and the seal ring can be disassembled for cleaning.
- The grinder jar can be rinsed with water. Or you can fill 2 cups of water into the jar, close the lid and then operate it in "Pulse" mode. Then pour out the water and dry it with soft cloth.
- Clean the unit base by soft cloth. Never put it in water.
- After cleaning, put the jar on the side or upside down to dry. Do not immerse the whole jar in water.
- If you put the jar in upside down position, please remove the residual water by dry cloth. Do not leave it close to the sink or basin, in order to avoid water spraying to the bottom part of the jar. This may cause rusting of the bearing and hence affect the performance of the grinder.

目錄

產品結構	07
操作說明	08
- 乾粉類食物	
- 麵團	
- 冰沙及奶昔	
清潔及維護	09
保用條款	11

產品結構

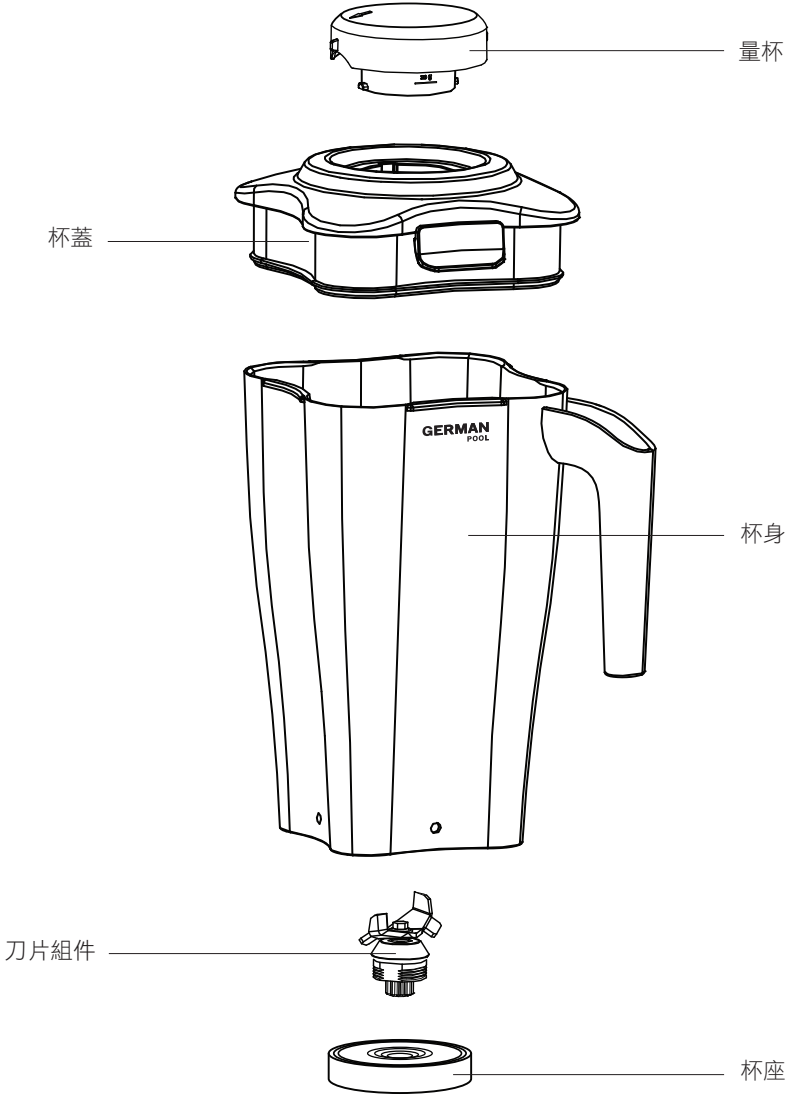

操作說明

乾粉類食物

做法：
將冰沙乾磨專用杯放置於專業高速健康食品處理器機座上，放入咖啡豆、黃豆、大米或糙米等食物，按「堅果」功能鍵即可乾磨成粉狀。

麵團

做法：
將冰沙乾磨專用杯放置於專業高速健康食品處理器機座上，放入麵粉及水(參考份量：麵粉250克 + 水140克)，按「堅果」功能鍵即可攪拌成麵團。

冰沙及奶昔

做法：
將冰沙乾磨專用杯放置於專業高速健康食品處理器機座上，放入生果，按「冰沙」功能鍵即成。

飲品例子：
以下材料份量供參考用（材料請順序加入），可根據個人喜好作出加減。

飲品	材料
芒果冰沙	芒果肉300克，冰塊2杯，白糖2湯勺
芒果奶昔	芒果肉300克，冰塊2杯，牛奶1/2杯，白糖2湯勺
草莓冰沙	草莓300克，冰塊2杯，白糖1湯勺
草莓奶昔	草莓300克，冰塊2杯，牛奶1/2杯，白糖1湯勺
香蕉冰沙	香蕉300克，冰塊2杯，白糖1湯勺
香蕉奶昔	香蕉300克，冰塊2杯，牛奶1/2杯，白糖1湯勺

清潔及維護

- 關掉開關鍵並拔掉電源插頭才能切掉電源。
- 切勿將機體座或電源線等置於水中或其他液體中。
- 清潔時用軟布或海綿輕輕擦洗杯子表面，杯蓋上的量杯可取出清洗。
- 使用後方杯可以用清水沖洗，也可倒入兩杯清水，蓋緊杯蓋，按瞬間動力鍵即可啟動清洗，再用軟布擦拭乾淨。
- 切勿用清水沖洗機體座，可用清潔軟布擦拭。
- 清洗完畢後請將杯橫放或倒放，讓其自然晾乾，不要將杯子整個浸泡於水中。
- 如將杯子倒放晾乾，請將杯底之水漬擦拭乾淨，並且遠離洗手台，以防水滴不慎流到杯底，造成軸承生水鏽，而使果汁杯損壞。

如欲獲取更多有關本產品最新資訊及食譜，歡迎瀏覽本公司網站。
For additional product information and cooking recipes, please visit our website.

www.germanpool.com

請填寫以下空格並與發票一併保存，以便維修時核對資料。用戶提供本公司之所有資料必須正確無誤，否則免費保用將會無效。
Please fill out the form below. This information and the purchase invoice will be required for any repairs. Warranty will be invalid if information provided is found to be inaccurate.

型號 Model No. : ☐ GSM-10

機身號碼 Serial No. : _____

發票號碼 Invoice No. : _____

購買商號 Purchased From : _____

購買日期 Purchase Date : _____

保用條款

此保用提供德國寶產品之機件在正常使用下壹年保用(自購買日起計算)。

* 貴戶須在購機十天內，以下列其中一種方式向本公司登記資料，保用手續方正式生效：

- 1) 填妥本公司網頁內之保用登記表格
www.germanpool.com/warranty。
- 2) 填妥保用登記卡，並連同購機發票之副本一併郵寄到客戶服務部 (本公司將不發還發票副本或登記卡)。

1. 未能出示購買發票正本者，將不獲免費維修服務。
2. 用戶應依照說明書的指示操作。本保用並不包括：
 - 上門安裝、檢驗、維修或更換零件之人工以及一切運輸費用；
 - 因天然與人為意外造成的損壞 (包括運輸及其他)；
 - 電源接合不當、不依說明書而錯誤或疏忽使用本機所引致之損壞。
3. 於下列情況下，用戶之保用資格將被取消：
 - 購買發票有任何非認可之刪改；
 - 產品被用作商業或工業用途；
 - 產品經非認可之技術人員改裝或加裝任何配件；
 - 機身編號被擅自塗改、破壞或刪除。
4. 總代理有權選擇維修或更換配件或其損壞部份。
5. 產品一經被轉讓，其保用即被視作無效。

維修部 – 小型電器

德國寶(香港)有限公司
香港九龍紅磡暢通道 1 號
中旅貨運物流中心8樓
電話：+852 2215 4582
傳真：+852 2355 7100
電郵：repairs@germanpool.com

Warranty Terms & Conditions

Under normal operations, the product will receive a 1-year full warranty provided by German Pool (effective starting from the date of purchase).

* This warranty is not valid until Customer's registration information is returned to and received by our Service Centre within 10 days of purchase via one of the following methods:

- 1) Visit our website and register online:
www.germanpool.com/warranty.
- 2) Complete all fields on the attached Warranty Card and mail it back to our Customer Service Centre along with a photocopy of the purchase invoice (Warranty Card and invoice copy will not be returned to Customer).

1. Customer who fails to present original purchase invoice will be disqualified for free warranty.
2. Customer should always follow the operating instructions. This warranty does not apply to:
 - labour costs for on-site installation, check-up, repair, replacement of parts and other transportation costs;
 - damages caused by accidents of any kind (including transport and others);
 - operating failures resulted from incorrect voltage, improper operations and unauthorized installations or repairs.
3. This warranty is invalid if:
 - purchase invoice is modified by unauthorized party;
 - product is used for any commercial or industrial applications;
 - product is repaired or modified by unauthorized personnel, or unauthorized parts are installed;
 - serial number is modified, damaged or removed from the product.
4. German Pool will, in its discretion, repair or replace any defective part.
5. This warranty will be void if there is any transfer of ownership from the original purchaser.

Repair Centre - Small Appliances

German Pool (Hong Kong) Limited
8/F, China Travel (Cargo) Logistics Centre
1 Cheong Tung Road
Hung Hom, Kowloon, Hong Kong
Tel : +852 2215 4582
Fax : +852 2355 7100
Email : repairs@germanpool.com

此保用證只適用於香港

This warranty card is valid only in Hong Kong

GERMAN POOL 德國寶

德國寶(香港)有限公司 German Pool (Hong Kong) Limited

香港九龍土瓜灣馬頭角道116號新寶工商中心高層地下2-4號室
Room 2 - 4, Upper Ground Floor, Newport Centre
116 Ma Tau Kok Road, Tokwawan, Kowloon, Hong Kong

電話 (Tel) :
+852 2333 6245
+852 2773 2888

傳真 (Fax) :
+852 2765 8215
+852 2365 6009

電郵 (E-mail) :
info@germanpool.com



© 版權所有。未獲德國寶授權，不得翻印、複製或使用本說明書作任何商業用途，違者必究。

© All rights reserved. Copying, reproducing or using the contents of this manual is not allowed without prior authorization from German Pool, violators will be prosecuted.

www.germanpool.com